

M-11/9 Extended Safety Installation Instructions

LAGE Manufacturing, L.L.C.
M11stuff@hotmail.com

- 1) Unload M-11/9 and remove magazine. Remove lower receiver from upper receiver. Using a 1/16" punch and a small hammer, punch out roll pin. Remove existing safety slide.

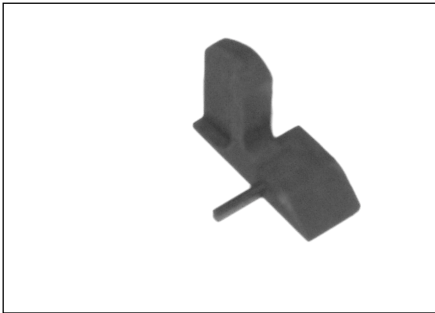

- 2) Using a small hammer, install roll pin through left side of extended safety. Seat it until it almost enters cavity for safety stub.



- 3) To protect the finish, place a piece of tape on the trigger guard side of the extended safety. Place extended safety on lower receiver, over safety stub.



- 4) Using a 1" C-clamp, place the fixed part of the clamp on the roll pin and position the swivel side on the other, over the tape. Tighten the C-clamp and drive the roll pin into the extended safety until it is flush. Remove C-clamp and tape. Re-assemble M-11/9.